



Medallion Fence

10651 KEELE STREET
 MAPLE, ONTARIO L6A 3Y9
 (T) 905-832-2922 || 1-800-794-1564 || (F) 905-832-1564
 info@medallionfence.com || www.medallionfence.com

Medallion Fence

STYLE:
STANTON

SERIES:
HAWKSTONE™

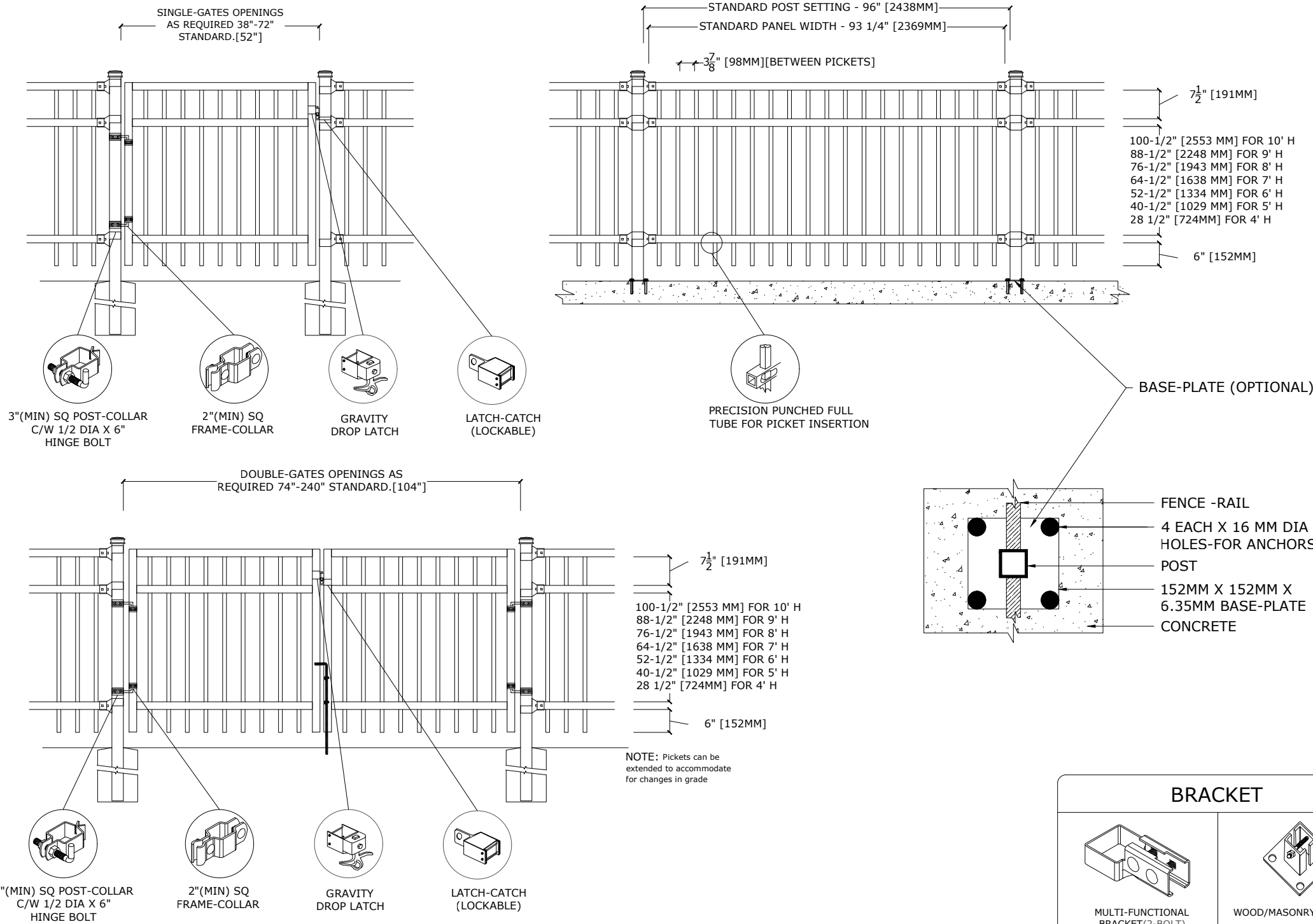

SPECIFICATIONS

TUBE COMPOSITION - POSTS , RAILS & PICKETS

- MINIMUM TENSILE STRENGTH: 45 KSI (310 MPA)
- MINIMUM TENSILE STRENGTH: 55 KSI (380 MPA)
- ASTM A787 (TUBE)
- TUBE MANUFACTURED FROM PRE-COATED ALUMINUM-ZINC COATED STEEL WITH COATING DESIGNATION AZ50 CONFORMING TO ASTM A792/A792M

MATERIAL DIMENSIONS

| | |
|---|--|
| PICKET | 1" x 1" (25mm x 25mm) 16GA |
| RAILS | 2" x 2" [50mm x 50mm] 14GA |
| POSTS REGULAR or BASE-PLATED | 3" x 3" [76mm x 76mm] 14 GA |
| OPTIONAL POST REGULAR or BASE-PLATED | Larger profiles available - contact Medallion Fence |
| UPRIGHTS | 2" x 2" [50mm x 50mm] 14GA |
| WELDS | Stainless Steel Mig Weld |
| FITTINGS | 12 Gauge Stamp Forged Finish as below |
| FITTING FASTENERS | JS1000 Plated Finish as below |
| OPTIONAL FASTENER | Tamper Proof Nuts |

FINISH

| | |
|---------------------|-------------------------------------|
| GRADE | Super Durable Polyester Powder Coat |
| OPTIONAL PRIMER | Zinc Rich Epoxy Powder Coat |
| OPTIONAL PRIMER (2) | E-Coat |
| STANDARD COLOUR | SEMI-GLOSS - BLACK |
| OTHER COLOURS | Green, Brown, White, Antique Silver |
| CUSTOM COLOURS | Per Specifications |

| | | | | | | | |
|-------------------------|---|--------------|--------------|--------------|--------------|--------------|---------------|
| STANDARD HEIGHTS | 4' 1219MM | 5' 1524MM | 6' 1892MM | 7' 2134MM | 8' 2438MM | 9' 2743MM | 10' 3048MM |
| | Custom heights are available (upon request) | | | | | | |

| | |
|----------------|-----------------------------------|
| STANDARD GATES | Passage, Double Entry, Cantilever |
|----------------|-----------------------------------|

STANDARD POST SETTING & PANEL WIDTH

| FOR FENCE HEIGHTS | PANEL WIDTH | POST SPACING [OPENING] |
|-------------------|------------------|------------------------|
| Up to 6' [1829mm] | 93 1/4" [2369MM] | 96" [2438 MM] |
| Over 6' [1829mm] | 93 1/4" [2369MM] | 96" [2438 MM] |

MATERIAL SPECIFICATIONS:

ARMOUR-SHIELD™
 BY MEDALLION FENCE

PROTECTED BY



OPTIONAL POST CAPS



PYRAMID



BALL

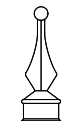

SPIRAL

SWIVEL BRACKET

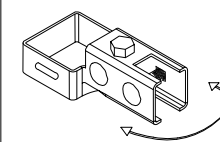

MULTI-FUNCTIONAL SWIVEL BRACKET

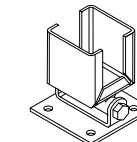

WOOD/MASONRY SWIVEL BRACKET

BRACKET

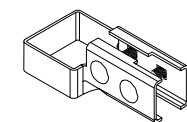

MULTI-FUNCTIONAL BRACKET (2-BOLT)

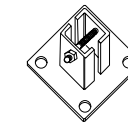

WOOD/MASONRY BRACKET