



# Medallion Fence

10651 KEELE STREET  
 MAPLE, ONTARIO L6A 3Y9  
 (T) 905-832-2922 || 1-800-794-1564 || (F) 905-832-1564  
 info@medallionfence.com || www.medallionfence.com

Medallion Fence

**STYLE:**  
**REGAL-A-AL**

**SERIES:**  
**OXFORD™**

SINGLE-GATES OPENINGS  
 AS REQUIRED 38"-72"  
 STANDARD.[56"]

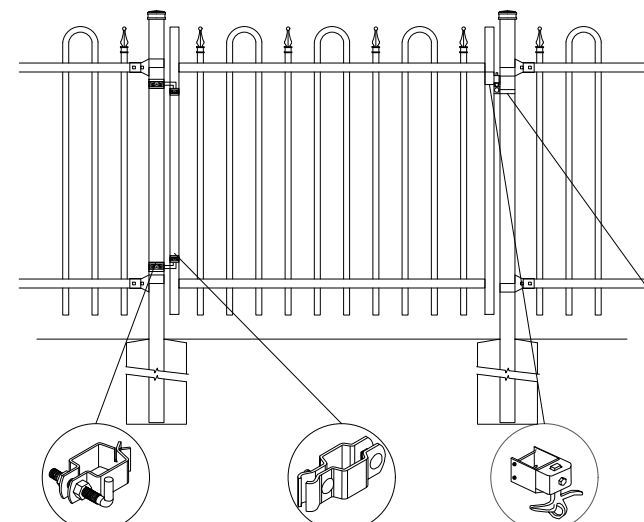

2-1/2" SQ POST-COLLAR  
 C/W 1/2 DIA X 4"  
 HINGE BOLT

1-1/2" SQ  
 FRAME-COLLAR

GRAVITY  
 DROP LATCH

LATCH-CATCH  
 (LOCKABLE)

DOUBLE-GATES OPENINGS AS  
 REQUIRED 74"-240" STANDARD.[112"]

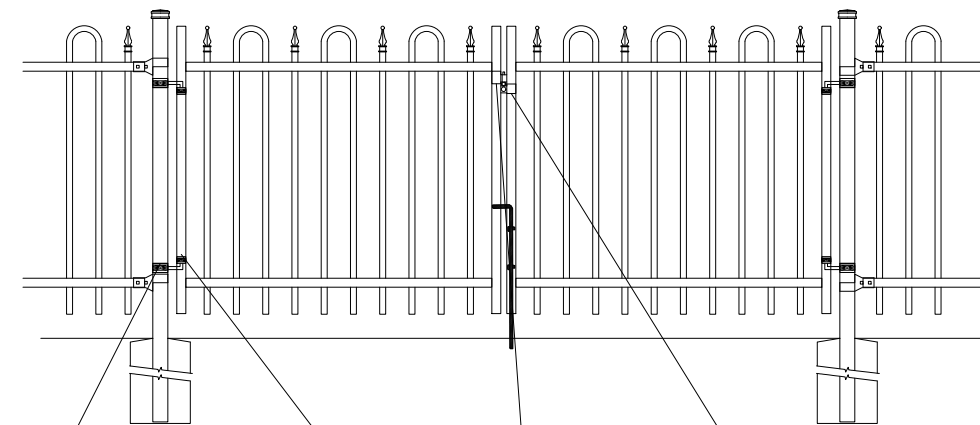

2-1/2" SQ POST-COLLAR  
 C/W 1/2 DIA X 4"  
 HINGE BOLT

1-1/2" SQ  
 FRAME-COLLAR

GRAVITY  
 DROP LATCH

LATCH-CATCH  
 (LOCKABLE)

STANDARD POST SETTING - 96" [2438MM]  
 STANDARD PANEL WIDTH - 93 1/4" [2369MM]

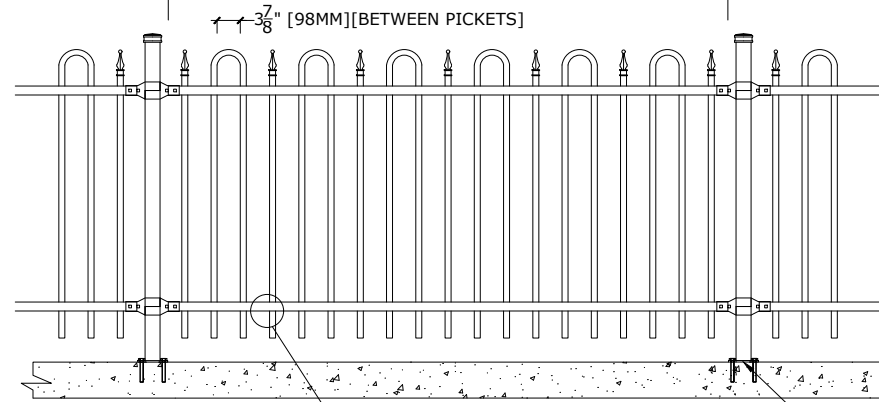

3/8" [98MM][BETWEEN PICKETS]

8" [203MM] FOR 6'-10" H  
 6" [152MM] FOR 4'-5" H

103" [2616MM] FOR 10' H  
 91" [2311MM] FOR 9' H  
 79" [2007MM] FOR 8' H  
 67" [1702MM] FOR 7' H  
 55" [1397MM] FOR 6' H  
 46 1/2" [1181MM] FOR 5' H  
 34 1/2" [876MM] FOR 4' H

6" [152MM] FOR 6'-10" H  
 4 1/2" [114MM] FOR 4'-5" H

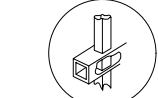

PRECISION PUNCHED FULL  
 TUBE FOR PICKET INSERTION

BASE-PLATE (OPTIONAL)

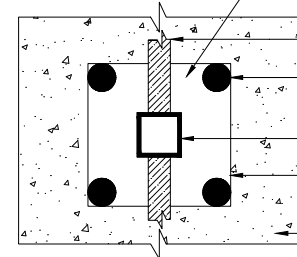

FENCE -RAIL

4 EACH X 16 MM DIA  
 HOLES-FOR ANCHORS

POST

152MM X 152MM X  
 6.35MM BASE-PLATE  
 CONCRETE

NOTE: Pickets can be  
 extended to accommodate  
 for changes in grade

### OPTIONAL CAST FINIAL

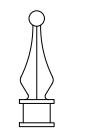

SPIRAL FINIAL (SF)

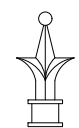

FLEUR DES LIS (FF)

### BRACKET

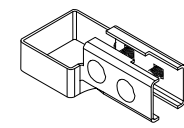

MULTI-FUNCTIONAL  
 BRACKET (2-BOLT)

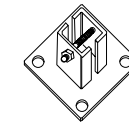

WOOD/MASONRY BRACKET

### OPTIONAL POST CAPS



PYRAMID



BALL



SPIRAL

### SWIVEL BRACKET

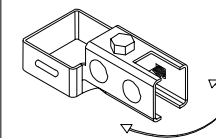

MULTI-FUNCTIONAL  
 SWIVEL BRACKET

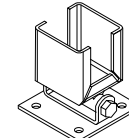

WOOD/MASONRY SWIVEL  
 BRACKET

### MATERIAL SPECIFICATIONS:

ALU-TUFF™  
 BY MEDALLION FENCE

PROTECTED BY



### SPECIFICATIONS

#### TUBE COMPOSITION - POSTS , RAILS & PICKETS

- HIGH-STRENGTH EXTRUDED ALUMINUM ALLOY (6061-T4 & 6061-T6 TEMPER)
- ULTIMATE TENSILE STRENGTH: ≈ 290 MPA (T4), ≈ 339 MPA (T6)
- YIELD STRENGTH: ≈ 210 MPA (T4), ≈ 317 MPA (T6)
- ELONGATION: ≈ 8%-16% (T6), UP TO ~16%+ (T4) DEPENDING ON THICKNESS

### MATERIAL DIMENSIONS

PICKET	1" x 1" (25mm x 25mm) .065 Wall
RAILS	1-1/2" x 1-1/2" (38mm x 38mm) .080 Wall
POSTS REGULAR or BASE-PLATED	2-1/2" x 2-1/2" (64mm x 64mm) .100 Wall
OPTIONAL POST REGULAR or BASE-PLATED	3" x 3" (76mm x 76mm) .188 Wall requires cast aluminum mounting bracket
UPRIGHTS	1-1/2" x 1-1/2" (38mm x 38mm) .100 Wall

<b>WELDS</b>	Aluminum Mig Weld
<b>FITTINGS</b>	12 Gauge Stamp Forged Finish as below
FITTING FASTENERS	JS1000 Plated Finish as below
OPTIONAL FASTENER	Tamper Proof Nuts

### FINISH

<b>GRADE</b>	Super Durable Polyester Powder Coat
OPTIONAL PRIMER	Zinc Rich Epoxy Powder Coat
OPTIONAL PRIMER (2)	E-Coat
STANDARD COLOUR	SEMI-GLOSS - BLACK
OTHER COLOURS	Green, Brown, White, Antique Silver
CUSTOM COLOURS	Per Specifications

<b>STANDARD HEIGHTS</b>	4'	5'	6'	7'	8'	9'	10'
	1219MM	1524MM	1892MM	2134MM	2438MM	2743MM	3048MM
Custom heights are available (upon request)							

STANDARD GATES	Passage, Double Entry, Cantilever
----------------	-----------------------------------

### STANDARD POST SETTING & PANEL WIDTH

<b>FOR FENCE HEIGHTS</b>	<b>PANEL WIDTH</b>	<b>POST SPACING [OPENING]</b>
Up to 6' [1829mm]	93 1/4" [2369MM]	96" [2438MM]
Over 6' [1829mm]	93 1/4" [2369MM]	96" [2438MM]