



# Medallion Fence

10651 KEELE STREET  
 MAPLE, ONTARIO L6A 3Y9  
 (T) 905-832-2922 || 1-800-794-1564 || (F) 905-832-1564  
 info@medallionfence.com || www.medallionfence.com

Medallion Fence

**STYLE:**  
**CAVALIER-DR-SF-REP**

**SERIES:**  
**OXFORD™**

SINGLE-GATES OPENINGS  
 AS REQUIRED 38"-72"  
 STANDARD.[48"]

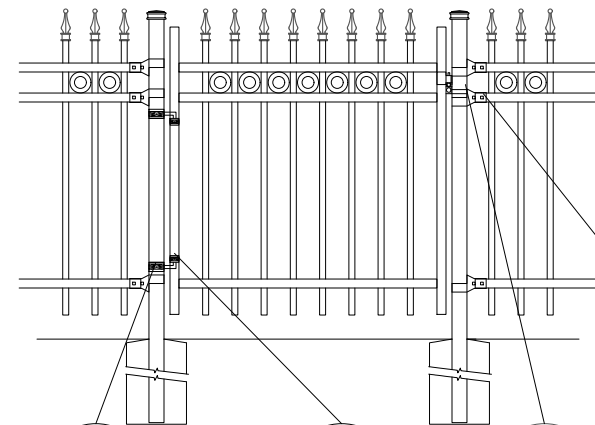

- 2-1/2" SQ POST-COLLAR  
C/W 1/2 DIA X 4"  
HINGE BOLT
- 1-1/2" SQ  
FRAME-COLLAR
- GRAVITY  
DROP LATCH
- LATCH-CATCH  
(LOCKABLE)

STANDARD POST SETTING - 96" [2438MM]  
 STANDARD PANEL WIDTH - 93 1/4" [2369MM]  
 3 7/8" [98MM][BETWEEN PICKETS]

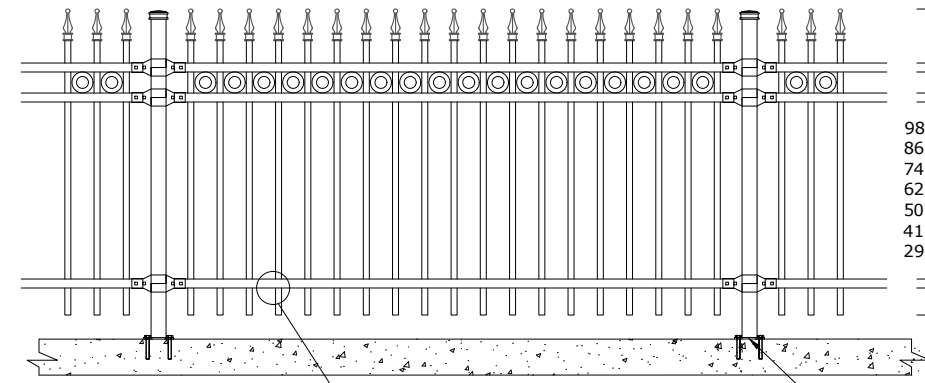

- 11" (279MM) FOR 6'-10" H  
9" (229MM) FOR 4'-5" H
- 3 1/2" [89MM]
- 98" (2489MM) FOR 10' H  
86" (2184MM) FOR 9' H  
74" (1880MM) FOR 8' H  
62" (1575MM) FOR 7' H  
50" (1270MM) FOR 6' H  
41-1/2" (1054MM) FOR 5' H  
29 1/2" [749MM] FOR 4' H
- 6" [152MM] FOR 6'-10" H  
4 1/2" [114MM] FOR 4'-5" H

- PRECISION PUNCHED FULL  
TUBE FOR PICKET INSERTION

BASE-PLATE (OPTIONAL)

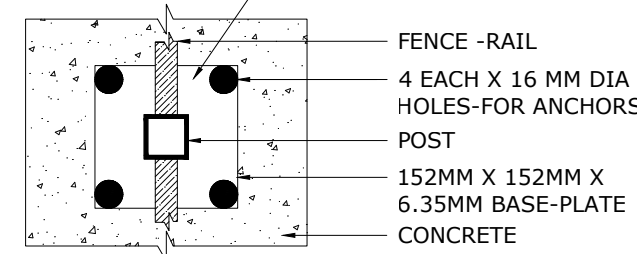

- FENCE -RAIL
- 4 EACH X 16 MM DIA  
HOLES-FOR ANCHORS
- POST
- 152MM X 152MM X  
6.35MM BASE-PLATE
- CONCRETE

DOUBLE-GATES OPENINGS AS  
 REQUIRED 74"-240" STANDARD.[96"]

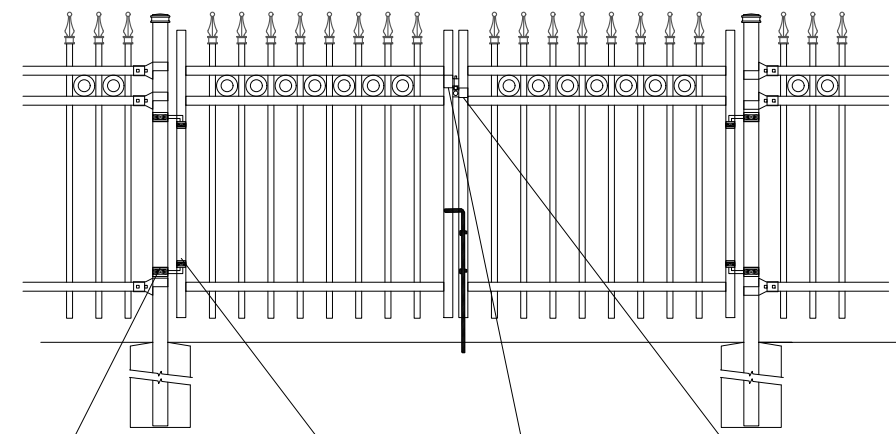

- 11" (279MM) FOR 6'-10" H  
9" (229MM) FOR 4'-5" H
- 3 1/2" [89MM]
- 98" (2489MM) FOR 10' H  
86" (2184MM) FOR 9' H  
74" (1880MM) FOR 8' H  
62" (1575MM) FOR 7' H  
50" (1270MM) FOR 6' H  
41-1/2" (1054MM) FOR 5' H  
29 1/2" [749MM] FOR 4' H
- 6" [152MM] FOR 6'-10" H  
4 1/2" [114MM] FOR 4'-5" H

NOTE: Pickets can be  
 extended to accommodate  
 for changes in grade

- 2-1/2" SQ POST-COLLAR  
C/W 1/2 DIA X 4"  
HINGE BOLT
- 1-1/2" SQ  
FRAME-COLLAR
- GRAVITY  
DROP LATCH
- LATCH-CATCH  
(LOCKABLE)

OPTIONAL CAST FINIAL

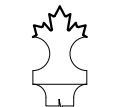

MAPLE LEAF

OPTIONAL CAST FINIAL



FLEUR DES LIS (FF)

BRACKET

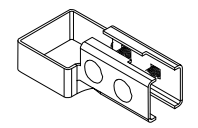

MULTI-FUNCTIONAL  
BRACKET (2-BOLT)

BRACKET

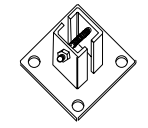

WOOD/MASONRY BRACKET

**MATERIAL SPECIFICATIONS:**  
 ARMOUR-SHIELD™  
 BY MEDALLION FENCE



OPTIONAL POST CAPS



PYRAMID



BALL

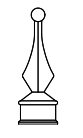

SPIRAL

SWIVEL BRACKET

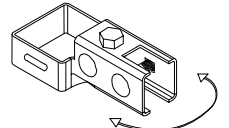

MULTI-FUNCTIONAL  
SWIVEL BRACKET

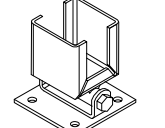

WOOD/MASONRY SWIVEL  
BRACKET

## SPECIFICATIONS

### TUBE COMPOSITION - POSTS , RAILS & PICKETS

- MINIMUM YIELD STRENGTH: 45 KSI (310 MPA)
- MINIMUM TENSILE STRENGTH: 55 KSI (380 MPA)
- ASTM A787 (TUBE)
- TUBE MANUFACTURED FROM PRE-COATED ALUMINUM-ZINC COATED STEEL WITH COATING DESIGNATION AZ50 CONFORMING TO ASTM A792/A792M

## MATERIAL DIMENSIONS

PICKET	1" x 1" (25mm x 25mm) 16 GA
RAILS	1-1/2" x 1-1/2" (38mm x 38mm) 14 GA
POSTS REGULAR or BASE-PLATED	2-1/2" x 2-1/2" (64mm x 64mm) 14 GA
OPTIONAL POST REGULAR or BASE-PLATED	HSS 3" (76mm) Sq./4" (102mm) Sq./6" (152mm) Sq.
UPRIGHTS	1-1/2" x 1-1/2" (38mm x 38mm) 14 GA
<b>WELDS</b>	Stainless Steel Mig Weld
<b>FITTINGS</b>	12 Gauge Stamp Forged Finish as below
FITTING FASTENERS	JS1000 Plated Finish as below
OPTIONAL FASTENER	Tamper Proof Nuts

## FINISH

<b>GRADE</b>	Super Durable Polyester Powder Coat
OPTIONAL PRIMER	Zinc Rich Epoxy Powder Coat
OPTIONAL PRIMER (2)	E-Coat
STANDARD COLOUR	SEMI-GLOSS - BLACK
OTHER COLOURS	Green, Brown, White, Antique Silver
CUSTOM COLOURS	Per Specifications

<b>STANDARD HEIGHTS</b>	4'-3" 1295MM	5'-3" 1600MM	6'-3" 1905MM	7'-3" 2210MM	8'-3" 2514MM	9'-3" 2819MM	10'-3" 3124MM
	Custom heights are available (upon request)						

STANDARD GATES	Passage, Double Entry, Cantilever
----------------	-----------------------------------

## STANDARD POST SETTING & PANEL WIDTH

<b>FOR FENCE HEIGHTS</b>	<b>PANEL WIDTH</b>	<b>POST SPACING [OPENING]</b>
Up to 6' [1829mm]	93 1/4" [2369MM]	96" [2438MM]
Over 6' [1829mm]	93 1/4" [2369MM]	96" [2438MM]